

D-Max Roof Rail Installation Guide

Image '1' provides a reference on where to find the mounting holes on the Colorado or D-Max. Please note that some models do not have these holes in which case you will need to drill the holes into your roof following the measurements provided. We recommend professional installation for drilling as incorrect drilling may void the warranty of our products as well as your car.

1. Measure out where the front holes can be found using image '1'. Place a small mark to note where the hole is. Mark out a line about 3cm towards the outside of these 2 holes. This is where you will cut. It does not have to be a perfect cut as the rubber is designed to be hidden underneath the rail when installed.

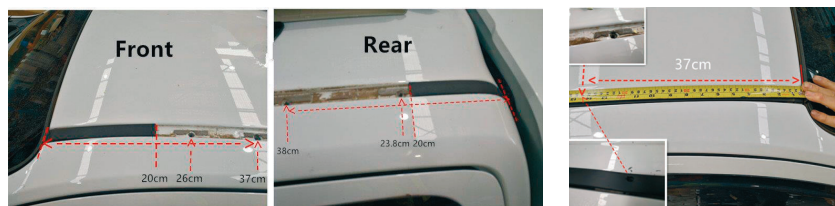

2. Do the same for the rear holes noting that you need to measure from the end of the rubber piece as shown in the image.

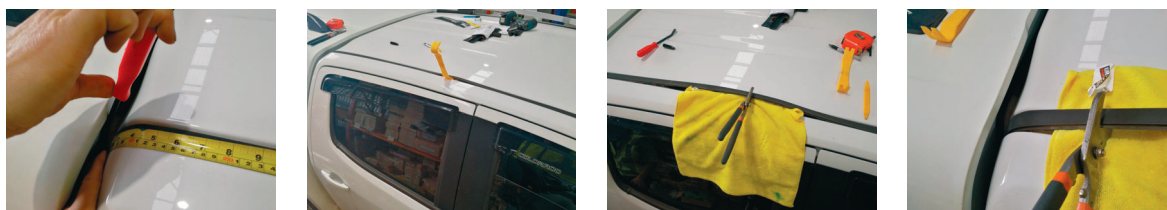

3. Using a plastic pry tool, gently pull up the rubber strip at the marked areas where you'll be cutting. Try to pull up as little as possible as the strip is held by 3M tape. If the tape is dried out or gets dirtied, then you may need to replace the 3M double sided tape to stick the rubber strip back on.

4,5,6. Make a cut at the marked lines.

7. Using a screwdriver or pry tool, gently poke the top of the hole to remove the sound deadener/insulation that comes from factory.



8. Remove any waste so you have full access to the threaded hole

9, 10. Position waterproofing rubber for front holes. Position waterproofing rubber for rear holes



11,12. Assemble front and rear brackets onto the rail and bolt the brackets down with the bolts provided



13,14. Gently push the the cap onto the brackets. Be careful with the tabs as they are quite delicate due to the design of the brackets.

Installation complete